

REMOVE (410 CC & 220 CC APPLICATIONS):

- Positive terminal on battery
- Old starter
- Adhesive backed vibration damper (if equipped)
- Airbox and Carburetor
- Blower Housing

INSTALLING NEW STARTER

1. Install new starter:

A. 410 cc application

- a) Make certain 45mm long Socket Head Capscrews are used.
- b) Use spacer 0C4373.
- c) One shim should be correct for most applications.

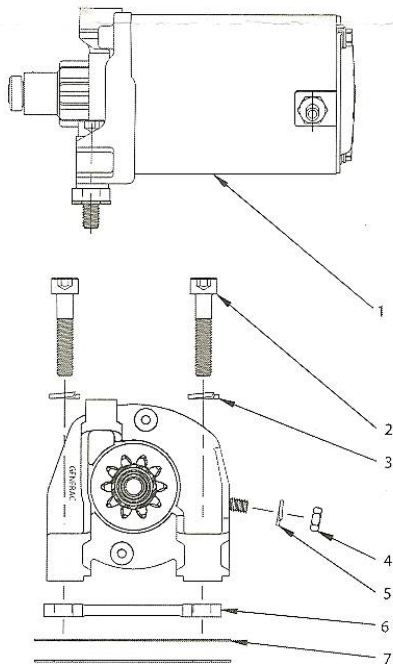

EXPLODED VIEW
STARTER KIT

B. 220 cc application

- a) Make certain 40mm long Socket Head Capscrews are used.
 - b) Do NOT use spacer.
 - c) One shim should be correct for most applications
2. Manually engage pinion on starter by turning it clockwise. Turn flywheel counterclockwise to aid. If the pinion will not engage the flywheel there is not enough clearance - add a shim.

**THE PINION MUST BE "TWISTED" INTO ENGAGEMENT
(DO NOT PULL IT INTO ENGAGEMENT)**

3. Measure backlash using wire gap gauges (*SEE FIGURE 1*).
4. ACCEPTABLE BACKLASH IS BETWEEN 0.5mm (0.020") AND 1.3mm (0.050").
5. Add or remove shims as needed to obtain acceptable backlash.
6. Reinstall Carburetor, Airbox, and Blower Housing.
7. Reset governor.

Figure 1 - Measuring Backlash

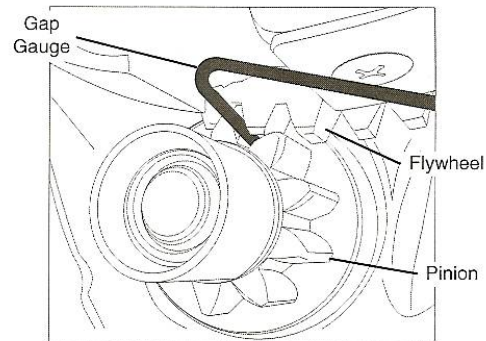

ITEM	191&220 (CUBIC CM)	360&410 (CUBIC CM)	APPLICATION
	QTY	QTY	DESCRIPTION
1	1	1	STARTER, 12VDC
2	2	-	BOLT, M8 X 40mm
2	-	2	BOLT, M8 X 45mm
3	2	2	LOCKWASHER, M8
4	1	1	NUT, M6
5	1	1	LOCKWASHER, M6
6	-	1	SPACER, 1/4"
7	2	2	SHIM, 0.80mm (0.031")
8	1	1	THIS INSTRUCTION SHEET